

SOLERA



STANDARD Exterior graphics



Scan here for available specs

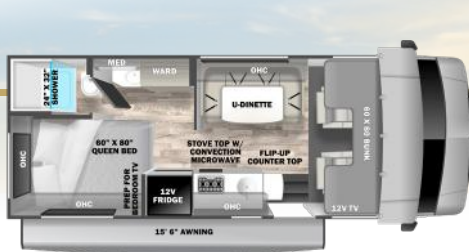

22N (Available on Ford E350/Chevy 3500)

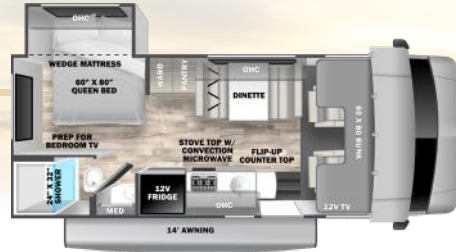

23S (Available on Ford E350/Chevy 3500)



SOLERA ON FORD E350 OR E450 CHASSIS

- Ford 7.3L V8 premium engine
- 6-Speed Ford TorqShift® automatic transmission



27DSE (Available on Ford E450)



32DSB (Available on Ford E450)

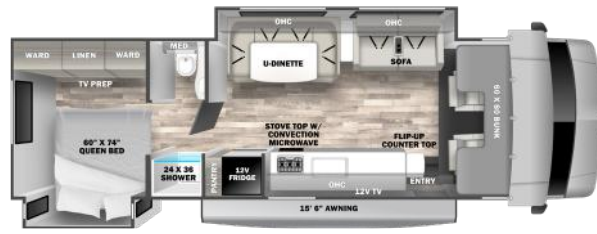

32DSK (Available on Ford E450)

OPTION

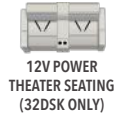

12V POWER THEATER SEATING (32DSK ONLY)



Mercedes-Benz

- Mercedes-Benz BlueTec 3.0L V6 diesel engine
- 188 HP with 325 lb.-ft. of torque

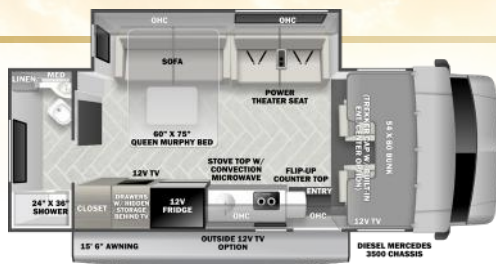

24SRB (Mercedes-Benz Sprinter 3500)



24SRC (Mercedes-Benz Sprinter 3500)

OPTION

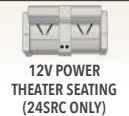

12V POWER THEATER SEATING (24SRC ONLY)

STANDARD FEATURES & OPTIONS

O: OPTION • S: STANDARD

WARRANTY

12 Months/12,000 mile basic limited warranty	S
Chassis warranty (see owners manual)	

SYSTEMS

Battery disconnect	S
Bilstein shock absorbers	S
Water heater bypass	S
(2) Deep cycle coach batteries	S
Easy access battery in step-well	S
30 Amp service with power cord	S
60 Amp Progressive Dynamics converter	S
6 Gallon DSI gas/electric water heater	S
30,000 BTU furnace	S
Emergency start switch	S
LED lighting	S
Satellite/cable connection	S
15,000 BTU ceiling ducted, ultra quiet roof air with heat pump (N/A with dual A/C option)	S
Dual A/C with heat pump and power shedding system (32DSB, 32DSK)	O
4.5 KW Gas generator (Ford/Chevy only)	S
3.6 KW LP generator (Mercedes only)	S
12V Heated tank pads	S
CO, LP and smoke detector	S
Winegard Air 360+ antenna with Gateway 4G WiFi capability	S
190 Watt roof mounted solar 12V charging system	S

EXTERIOR

Aluminum framed laminated sidewalls	S
Superlite composite substrate	S
Gel coat exterior fiberglass	S
Block foam insulation	S
Lighted power awning	S
Slide room toppers	S
Fiberglass roof	S
Heated power exterior mirrors	S
One-piece fiberglass front cap	S
Roto-cast storage compartments	S

EXTERIOR - continued

Aluminum running boards	S
Tinted sliding windows	S
7,500 Lbs. hitch, 7-pin connector (E450)	S
5,000 Lbs. hitch, 7-pin connector (E350/Chevy)	S
4,200 Lbs. hitch, 7-pin connector (Mercedes)	S
Exterior speakers	S
Integrated entry step	S
Automatic leveling system (4-point)	O
Black tank flush	S
On-The-Go™ Ladder Bracket (most models)	S

CAB AREA

Passenger swivel captains chair with booster (N/A 32DSB)	S
Power windows and door locks	S
Keyless entry	S
Back-up and side view camera system	S
10" In-dash touch screen Apple Carplay/Android Auto™ radio	S

KITCHEN

Recessed 3-burner range with flush glass cover (2-Burner range Mercedes)	S
10.7 Cu. ft. 12V refrigerator	S
1.3 Cu. ft. convection microwave oven	S
Wireless 12V charging pad in kitchen	S
Soft touch self-closing drawer guides	S

BATHROOM

Electric roof fan	S
Oxygen-infused shower head with flexible extension	S
Shower skylight	S

LIVING ROOM

MCD roller shades	S
Residential style furniture with Fortress stain resistant fabrics	S
12V LED flat panel adjustable side TV	S
Child seat head tethers in dinette	S
Multi-speed power fan with cover	S
Power theater seating (24SRC, 32DSK)	O

POPULAR FEATURES

- Fiberglass laminated roof
- Enclosed underbelly (Most models)
- Winegard 360 plus antenna with Gateway WIFI capability
- 15K AC with heat pump (Some models offer Dual AC option)
- 10.7 Cu. Ft. 12V refrigerator
- 12V dual solar charging system (Chassis and house batteries)

SOLERA

Visit: www.forestriverinc.com/solera
 914 CR 1 • Elkhart, IN 46514
 574.262.2212 • 800.445.2825



Learn More
 Scan this barcode using a QR Reader on your smart phone to learn more about Forest River.



All information contained in this brochure is believed to be accurate at the time of publication. However, during the model year, it may be necessary to make revisions and Forest River, Inc., reserves the right to make all such changes without notice, including prices, colors, materials, equipment and specifications as well as the addition of new models and the discontinuance of models shown in this brochure. Therefore, please consult with your Forest River dealer and confirm the existence of any materials, design or specifications that are material to your purchase decision. ©2023 Forester - a Division of Forest River, Inc. - a Berkshire Hathaway Company 9/23



LaMesa RV
 LaMesaRV.com
 800-496-8778